

Fellowes

AIR PURIFIERS

Array AR1

Recessed Air Purifier
Purificateur d'air encastré
Purificador de aire empotrado



Install Guide

Guide d'installation
Guía para la instalación

PLEASE READ THESE INSTRUCTIONS BEFORE USE.
DO NOT DISCARD: KEEP FOR FUTURE REFERENCE.

VEUILLEZ LIRE CES INSTRUCTIONS AVANT D'UTILISER L'APPAREIL.
NE PAS JETER : CONSERVER AFIN DE CONSULTER LES DIRECTIVES
ULTÉRIEUREMENT, EN CAS DE BESOIN.

LEA ESTAS INSTRUCCIONES ANTES DEL USO.
NO LAS DESECHE: CONSÉRVELAS PARA REFERENCIA FUTURA.

PACKAGING CONTENTS

- Air Purifier (1X)
- Hybrid Filters w/ Pre-Filter (1X)
- 16ft mounting cables with clutches (4X)
- Centering Blocks (4X)
- User Manual (1X)

TOOLS REQUIRED FOR INSTALLATION

- Gloves
- Ladder/Step Stool
- UL Elbow or Conduit
- Wire Nuts
- Level
- Tape
- Unobstructed 24" x 24" drop ceiling grid with at least 24" clearance above the drop ceiling
- Mounting hooks or location installed to local code and capable of holding the weight of the system
- For ease of installation and optimal placement of unit in the grid, it is **HIGHLY RECOMMENDED** that either hooks be drilled into the ceiling, or strut channels be used to loop cables if there are no existing mounting points available above the perimeter of the housing.

NOTE: Three people are recommended for easy and proper installation

NOTE: We recommend removing adjacent ceiling tiles for easiest installation

NOTE: It is required to remove one cross-tee in the ceiling grid, which will make installation much easier

NOTE: Do not install next to a return or register

NOTE: Shut off circuit breaker to installation area before beginning installation

INSTALLATION INSTRUCTIONS

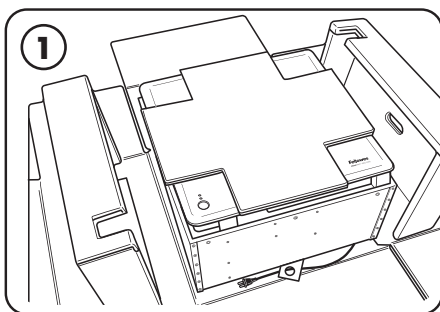

1 Before beginning installation, ensure that a qualified electrician has run a 120V circuit to the installation area. Remove unit from packaging and stage on a tabletop or other surface under or near installation area with door facing upwards.

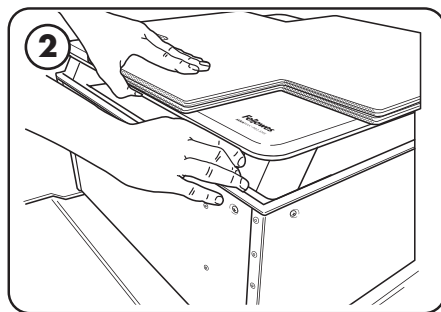

2 Open unit door by depressing the latch button and pulling upward. Have one person hold the door open for the next few steps or the hinges can be damaged.

NOTE: do not remove corrugate support trays attached to door yet.

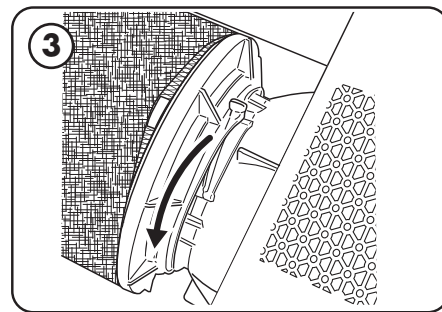

3 Disengage the filter clamp lever until a click is heard.

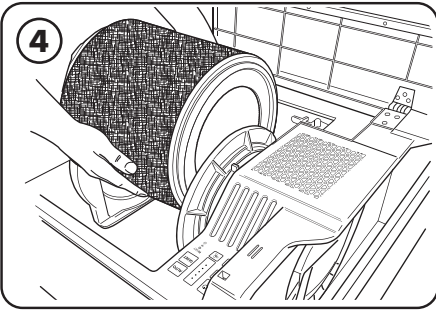

4 Pull filter out by the strap and set aside for now.

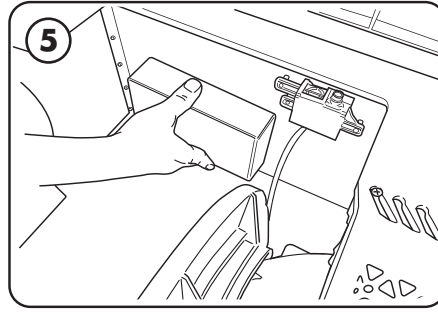

5 Remove mounting hardware and verify included part quantities.

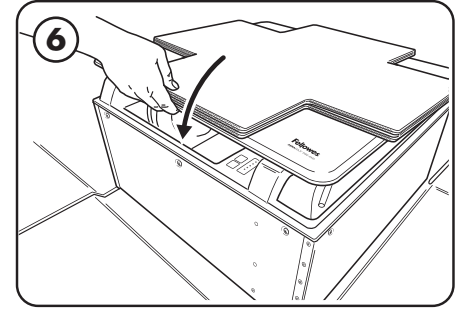

6 Close the door until a click is heard. Depending on type of ceiling, attach proper mounting hardware above installation area per local regulations for supporting a 52lb (24kg) fixture. Ideally the mounting locations would be 23" apart in the shape of a square.

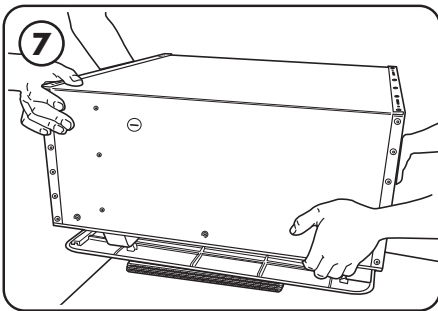

7 Lift and rotate unit before setting door-side down on the provided trays. Determine which electrical knockout will be used and remove it.

⚠ WARNING: do not place directly on any flat surface as this will damage the sensor that sticks below the bottom surface.

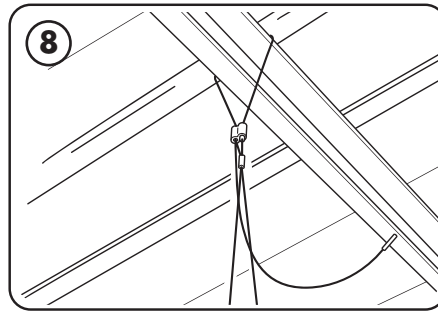

8 Loop open end of cables through intended support or hardware. Use provided cable clutch hardware to secure each cable.

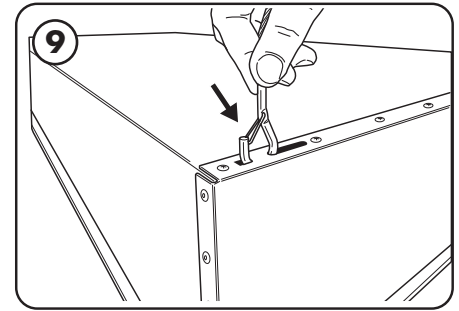

9 Secure the hooks from the provided aircraft cabling to the housing through the mounting holes (P7).

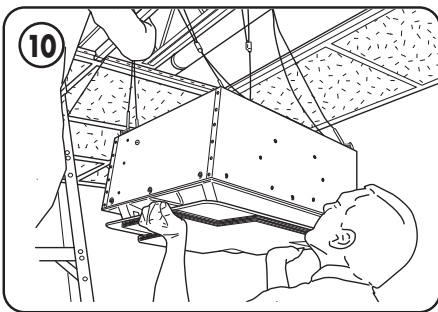

10 Have one person slowly lifting the machine while the other pulls the free end of the cables to keep them taut.

Alternate slowly raising each side to keep the unit relatively level during lifting.

⚠ WARNING: During lifting ensure hooks stay oriented correctly and do not get misaligned or they may not hold properly.

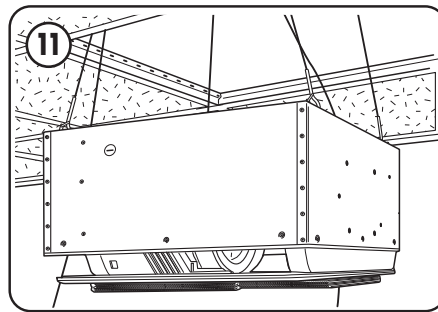

11 Raise the fixture to about 1-2 feet below the ceiling grid on the cables.

NOTE: If unit is raised too high, have one person raise the unit while the other depresses the spring section on the wire clutch, allowing the cable to be loosened.

CAUTION: To reduce the risk of injury to persons, install fan at least 2.1 m (6.9 ft) above the floor.

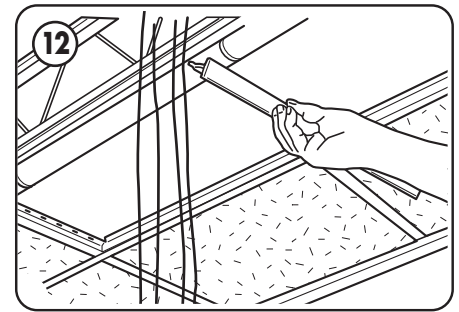

12 If you have not yet, remove the adjacent cross-tee, tilt fixture about 45° upward toward the grid's long tees.

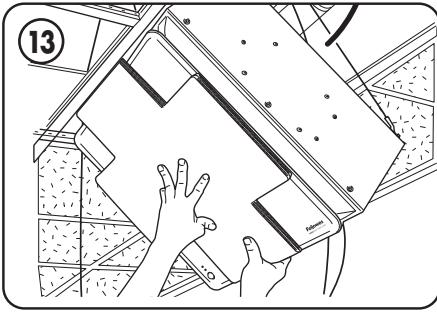

Rotate and lift all the way through the grid until fixture can be straightened above the ceiling grid ensuring bottom panel is not damaged.

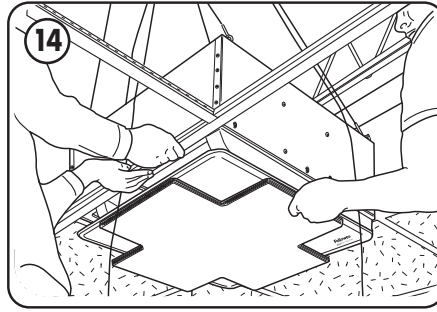

With one person supporting fixture so it just touches the grid, the other should pull the aircraft cables until taut.

⚠ WARNING: Grid is not meant to support weight of product.

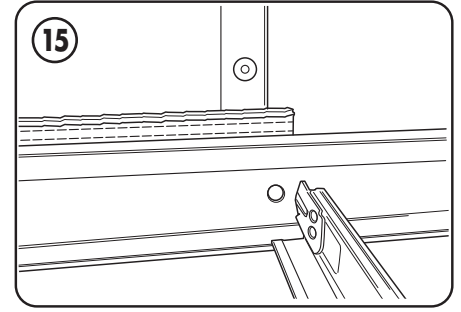

Check below unit for visible gaps. If needed, add centering blocks between unit and grid. Trim out as desired.

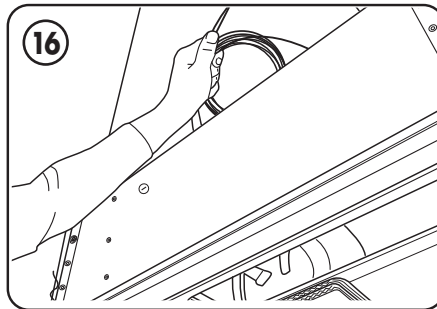

Coil and wrap remaining cable out of the way. Do not trim excess cable lengths. Re-install the cross-tee.

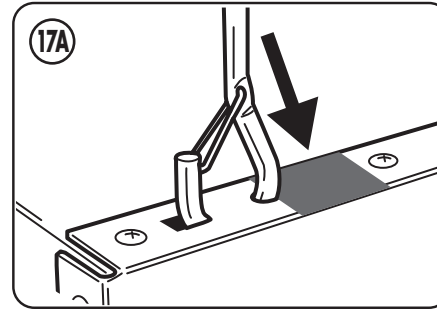

Tape off the hook slots as shown.

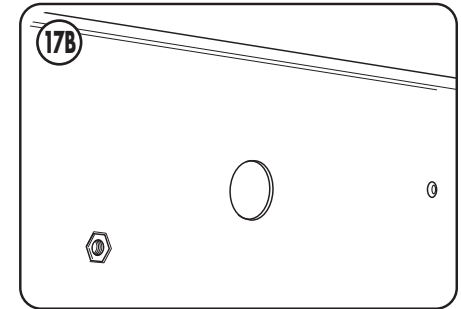

Working from above the unit, attach a UL approved straight or 90° elbow to connect conduit.

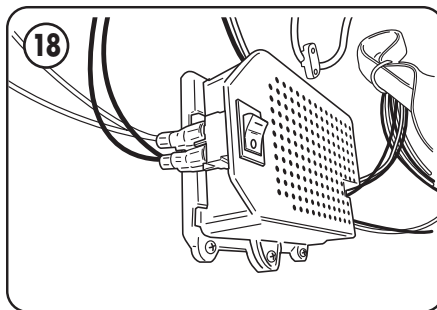
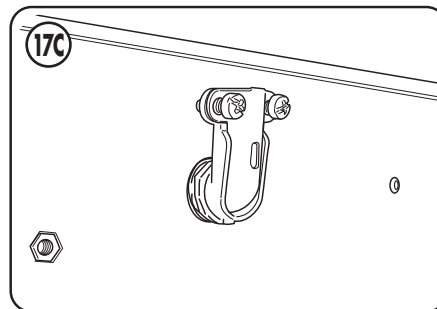
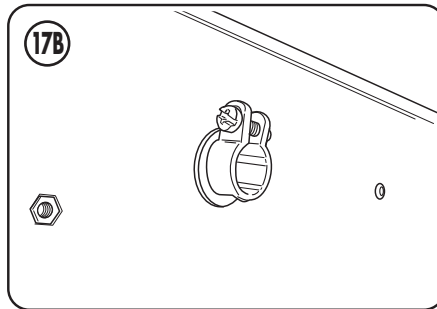

Ensure power switch located on the power supply is in the off position before proceeding with connecting any wires.

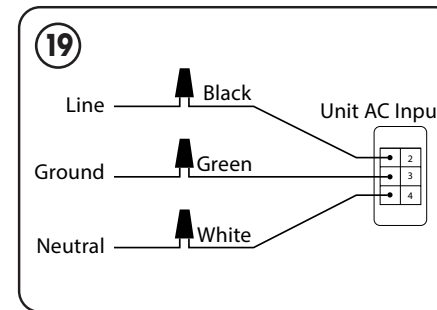

Have a qualified electrician connect the ground, line, and neutral to fixture per local electrical codes.

Turn on power supply switch.

Now the unit is set up and can be controlled with the buttons behind the filter door.

All wirings connected in junction box should be connected with twist connectors.

FILTER INSTALLATION PROCEDURE

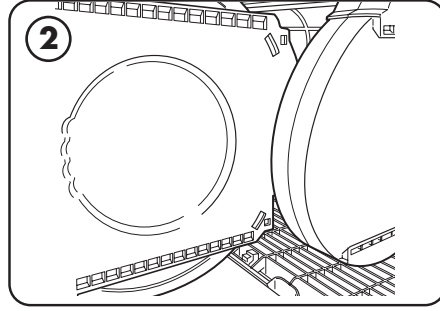
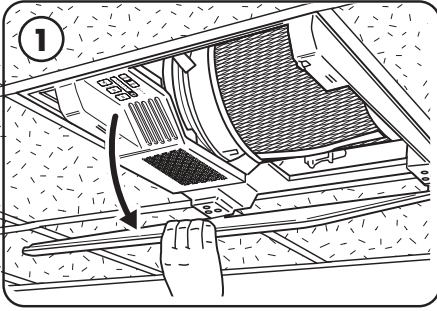

Remove new filter from protective bag and properly dispose of bag.
Holding the filter by the strap, align support cleat with slot.

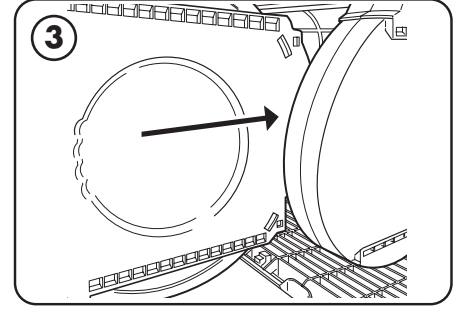

Gently push in filter until a click is heard.
NOTE: if top and bottom supports are not properly aligned, the filter will not sit properly and can damage the unit.

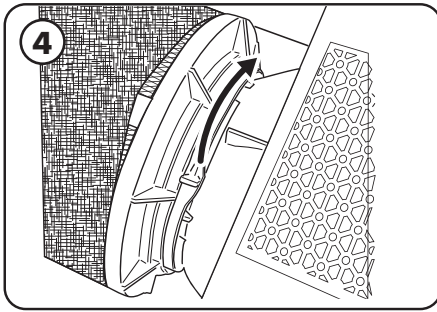

Secure filter into place by moving filter clamp lever back into the locked position until a click is heard.

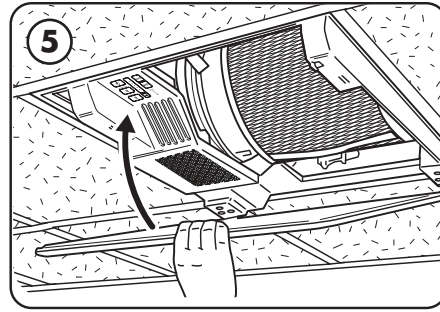

Close door until a click is heard. After closing door, press door closed on corners and directly beneath latch to ensure magnets and latch are fully secured.

Fellowes

AIR PURIFIERS

Array AR1

Recessed Air Purifier
Purificateur d'air encastré
Purificador de aire empotrado



PLEASE READ THESE INSTRUCTIONS BEFORE USE.
DO NOT DISCARD: KEEP FOR FUTURE REFERENCE.

VEUILLEZ LIRE CES INSTRUCTIONS AVANT D'UTILISER L'APPAREIL.
NE PAS JETER : CONSERVER AFIN DE CONSULTER LES DIRECTIVES
ULTÉRIEUREMENT, EN CAS DE BESOIN.

LEA ESTAS INSTRUCCIONES ANTES DEL USO.
NO LAS DESECHE: CONSÉRVELAS PARA REFERENCIA FUTURA.

*For a copy of the manual please visit www.fellowes.com

⚠ WARNING: IMPORTANT SAFETY INSTRUCTIONS — READ AND SAVE THESE INSTRUCTIONS

Read carefully before attempting to assemble, install, operate or maintain this product. Protect yourself and others by observing all safety information.

Failure to comply with instructions could result in personal injury and/or property damage.

Retain instructions for future reference.

⚠ WARNING – TO REDUCE THE RISK OF FIRE, ELECTRIC SHOCK, OR INJURY TO PERSONS, OBSERVE THE FOLLOWING:

- a) Use this unit only in the manner intended by the manufacturer. If you have questions, contact the manufacturer.
 - b) Before servicing or cleaning unit, switch power off at service panel and lock the service disconnecting means to prevent power from being switched on accidentally. When the service disconnecting means cannot be locked, securely fasten a prominent warning device, such as a tag, to the service panel.
- Do not use this air purifier as sole protection against harmful pollutants.
 - Do not repair or modify the product unless specifically recommended in this manual. Only an authorized repair technician should disassemble, repair, or modify this product.
 - Installation work and electrical wiring must be done by qualified person(s) in accordance with all applicable codes and standards, including fire-rated construction.
 - Do not install this product near heat-generating equipment.
 - **⚠ WARNING:** This product will not remove carbon monoxide emitted from heating appliances or other sources.
 - **⚠ WARNING:** to prevent personal injury do not use the product near flammable substances or a gas leak.
 - The product must be grounded.
 - Use only the electrical power (voltage and frequency) specified for the model air purifier being installed.
 - When cutting or drilling into wall or ceiling, do not damage electrical wiring and other hidden utilities.
 - Do not use the unit where it is humid or where the unit may get wet.
 - **⚠ WARNING:** to reduce the risk of fire or electric shock, do not use this product with any solid-state speed control device.
 - Do not obstruct the air inlet or air outlet.
 - This product is for indoor use only.
 - Change your filters at the recommended intervals to avoid particle and dust buildup.
 - Ensure filter bags are removed and correctly installed before turning on. Do not operate this product without filters.
 - Do not wash and reuse any of the filters.
 - Do not use attachments or filters other than AeraMax® Pro brand, as product will not function.
 - **⚠ WARNING:** to avoid risk of personal injury do not spray aerosols on, or into the product.
 - Do not use detergents to clean the product.
 - Do not insert fingers, liquids, or foreign objects into the air intake or outlets. Use a clean cloth to wipe down exterior surface if needed.
 - Do not use this product for anything other than air purification.
 - This appliance can be used by children aged from 8 years and above and persons with reduced physical, sensory, or mental capabilities or lack of experience and knowledge if they have been given supervision or instruction concerning use of the appliance in a safe way and understand the hazards involved
 - **⚠ WARNING:** To reduce the risk of fire, electric shock, or injury to persons, do not use replacement parts that have not been recommended by the manufacturer (e.g. parts made at home using a 3D printer).
 - This device contains licence-exempt transmitter(s)/receiver(s) that comply with Innovation, Science and Economic Development Canada's licence-exempt RSS(s). Operation is subject to the following two conditions:
 1. This device may not cause interference.
 2. This device must accept any interference, including interference that may cause undesired operation of the device.

PRODUCT SPECIFICATIONS

Dimensions	23.4 X 23.4 X 12.4 in	595 X 595 X 314 mm
Weight of System	40.3 lbs	18.3 kg
Power Requirements	AC 120V 60Hz 0.8 A	
Rated Watts	96W	

CONTROLS

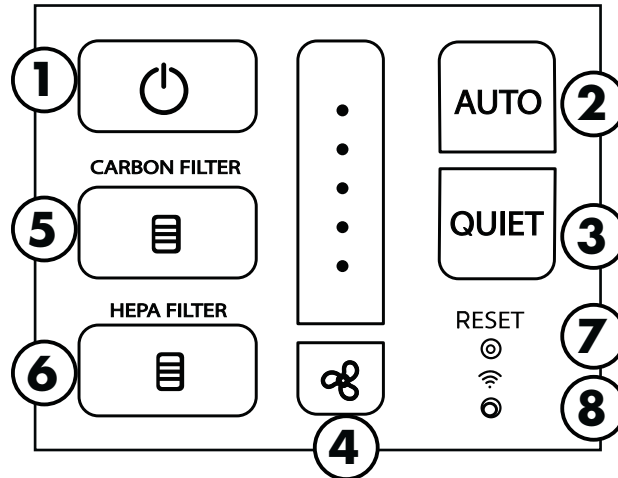

NOTE: To access unit controls, open unit door by depressing the door latch button and pulling downward

- 1 POWER** – Pressed - sets the unit to OFF or ON mode.
 OFF Mode: All indicators are off, fans are off, sensors still collect data, only power button is ON.
 ON mode: Initializes into Auto mode. Subsequent uses set unit at the last mode setting (Manual/Auto/Quiet). Fans on, sensors on, Air Quality Indicator light on:
 – BLUE when air quality is Good.
 – AMBER when air quality is Fair.
 – RED when air quality is Poor.
 – WHITE when door is open
- 2 AUTO** – Press: sets the unit to Auto mode
 Light: indicates unit is running in Auto mode where air quality sensors set fan speed automatically depending on environment.
 Indicator will stay lit if feature is active, but will only function if door is closed.
- 3 QUIET** – Press: sets the unit to Quiet Auto mode.
 Light: indicates unit is running in Quiet Auto mode where air quality sensors set fan speed automatically depending on environment but will not exceed fan speed 3.
 Indicator will stay lit if feature is active, but will only function if door is closed.
- 4 MANUAL** – Press: cycle through fan speeds. If coming from Auto mode, will start at lowest fan speed.
 Light: indicates which fan speed is currently selected (1-5).
- 5 CARBON FILTER** – Press for 2s: reset the life counter of the carbon filter.
 Light (red): indicates filter life has reached 100%. An external LED will also light (red) if any filter is over 100% life.
- 6 HEPA FILTER** – Press for 2s: reset the life counter of the HEPA filter.
 Light (red): indicates filter life has reached 100%. An external LED will also light (red) if any filter is over 100% life.
- 7 RESET** – Press for 10s: connection reset.
- 8 WIRELESS STATUS** –
 GREEN = Fully Connected & Paired
 YELLOW = Connection Available
 RED = Not Connected
 RED (Blink) = Connection Error
 BLUE = Reset Initialized
 BLUE (Blink) = Reset Confirmed
 OFF = Connection Disabled

FILTER CHANGE PROCEDURE

Unit will notify you when filter needs to be changed with a red led visible on the bottom of the unit. Always wear a mask and gloves when performing a filter change. For replacement filters, please visit: www.fellowes.com

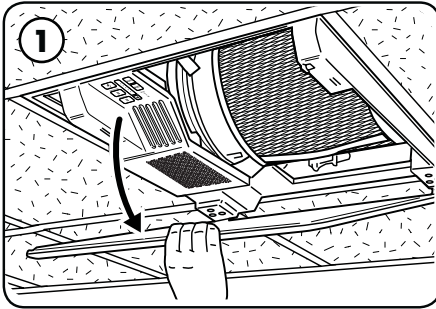

Open the door by depressing the latch button and pulling down on the door.

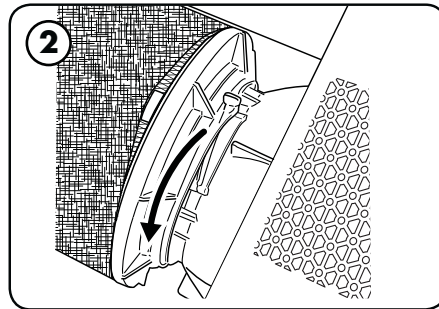

Disengage the filter clamp lever until a click is heard, pull used filter out by the strap and dispose.

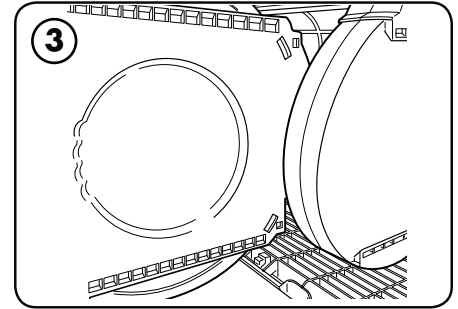

Remove new filter from protective bag and properly dispose of bag. Holding the filter by the strap, align support cleat with slot.

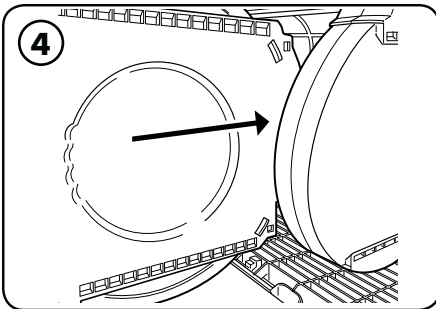

Gently push in filter until a click is heard.
NOTE: if top and bottom supports are not properly aligned, the filter will not sit properly and can damage the unit.

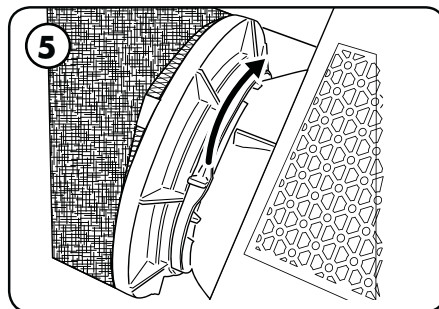

Secure filter into place by moving filter clamp lever back into the locked position until a click is heard.

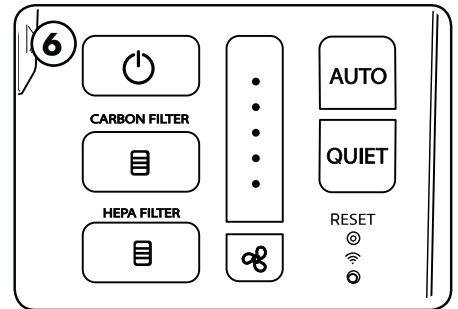

Press the carbon or HEPA filter buttons that are lit up to reset the filter life indicators.

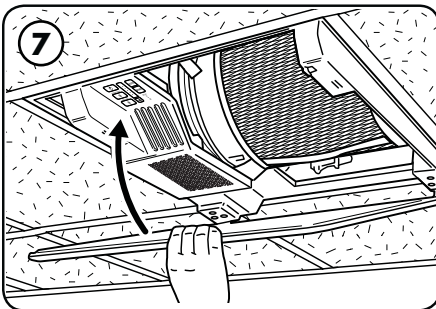

Close door until a click is heard. After closing door, press door closed on corners and directly beneath latch to ensure magnets and latch are fully secured.

WIRELESS CONNECTION – GETTING STARTED

This product has additional features that are only available when using the online dashboard. To get started, please visit www.arrayviewpoint.fellowes.com. If you have questions or need help along the way, please contact us at 1-800-955-0959

MAINTENANCE AND CLEANING

Power down machine before starting maintenance.
Use dust cloth to remove dust and debris that may have built up around the unit internals.
Note: Do not attempt to clean inside fan blade area. Damage may occur to blades.
Note: Do not use the dust cloth to clean the filters.
If there is dust and debris near the exhaust areas of the unit, gently use a dust cloth to loosen the dust. Once complete, turn the unit on, and close the door.

TROUBLESHOOTING

PROBLEM:	POSSIBLE SOLUTION:
How do I turn on the unit?	<ul style="list-style-type: none">• Make sure the power switch on top of the unit is flipped to the on position, indicated by the 'I' symbol. Next, open the door and press the power button on the control panel.
What does the red light under the unit mean?	<ul style="list-style-type: none">• This means the filter needs to be replaced. Please replace and reset the indicator
How do I reset my filters life indicator?	<ul style="list-style-type: none">• Press the "HEPA Filter" button until it is no longer red.
How do I get the filters out of the unit?	<ul style="list-style-type: none">• Ensure the finger paddle on the filter change mechanism is in the unlocked position. Then grab the filter handle strap and firmly pull on the filter to dislodge.
How do I get the filters back into the unit?	<ul style="list-style-type: none">• Ensure finger paddle on the filter change mechanism is in the unlocked position, the filter is oriented so the French cleat support can be used, and the French cleat is seated correctly.

WARRANTY

Fellowes, Inc. ("Fellowes") warrants the AR1 ("Product") to be free from defects in material and workmanship for the time periods as set forth below.

The particle counters, IOT, and sensors for a period of three (3) years from the date of original purchase of the Product.

All other parts for a period of five (5) years from the date of original purchase of the Product.

In the event that the Product is installed into new construction, the warranty period shall commence on the date of the occupancy permit or one year after the date of purchase, whichever is earlier. If any part is found to be defective during the warranty period, Fellowes will (at its sole option) either repair or replace the defective product with no charge for service or parts.

This warranty does not cover damage caused by use of non-Fellowes approved filters or failure to follow the recommended replacement schedule. This warranty does not apply in the cases of abuse, mishandling, failure to comply with product usage standards, operation using an improper power supply (other than listed on the label), installation error, or unauthorized repair. This warranty does not cover replaceable filters.

Fellowes reserves the right to charge the consumer for any additional cost occurred by Fellowes to provide parts or service outside of the country where the Product was initially sold by an authorized reseller. In the event that the Product is not readily accessible to Fellowes designated service personnel, Fellowes reserves the right to supply the customer with replacement parts or product in full satisfaction of its obligations under this warranty and any service obligations. **ANY IMPLIED WARRANTY, INCLUDING THAT OF MERCHANTABILITY OR FITNESS FOR A PARTICULAR PURPOSE, IS HEREBY DISCLAIMED IN ITS ENTIRETY IN LIEU OF THE EXPRESS WARRANTY SET FORTH ABOVE.** In no event shall Fellowes be liable for any consequential, incidental, indirect or special damages. This warranty gives you specific legal rights. The duration, terms, and conditions of this warranty are valid worldwide, except where different limitations, restrictions, or conditions may be required by local laws. For more details or to obtain service under this warranty, please contact us or your dealer.

INFORMATION TO THE USER

This product is classified as Electrical and Electronic Equipment. Should the time come for you to dispose of this product please ensure that it is not mixed with general household waste. For proper treatment, recovery, and recycling, please take this product to a designated collection point. Please contact your local authority for further details of your nearest designated collection point

This equipment has been tested and found to comply with the limits for Class B digital device, pursuant to part 15 of the FCC Rules. These limits are designed to provide reasonable protection against harmful interference in an installation. This equipment generates, uses and can radiate radio frequency energy and, if not installed and used in accordance with the instructions, may cause harmful interference to radio communications. However, there is no guarantee that interference will not occur in a particular installation. If this equipment does cause harmful interference to radio or television reception, which can be determined by turning the equipment off and on, the user is encouraged to try to correct the interference by one or more of the following measures:

- Reorient or relocate the receiving antenna
- Increase the separation between the equipment and receiver
- Connect the equipment on a circuit different from that to which the receiver is connected.
- Consult the dealer or experienced radio/TV technician for help.