

Fellowes

A I R P U R I F I E R S

Array AC2

Ceiling Mounted Air Purifier

Purificateur d'air de plafond

Purificador de aire montado en el techo



Installation Guide Guide d'installation Guía de instalación

PLEASE READ THESE INSTRUCTIONS BEFORE USE.
DO NOT DISCARD: KEEP FOR FUTURE REFERENCE.

VEUILLEZ LIRE CES INSTRUCTIONS AVANT D'UTILISER L'APPAREIL.
NE PAS JETER : CONSERVER AFIN DE CONSULTER LES DIRECTIVES
ULTÉRIEUREMENT, EN CAS DE BESOIN.

LEA ESTAS INSTRUCCIONES ANTES DEL USO.
NO LAS DESECHE: CONSÉRVELAS PARA REFERENCIA FUTURA.

PACKAGING CONTENTS

- Air Purifier (1X)
- Hybrid Filters w/ Pre-Filter (2X)
- 16ft mounting cables with clutches (2X)
- Thank You Card (1X)
- Quick Start Guide (1X)
- User Manual (1X)

TOOLS REQUIRED FOR INSTALLATION

- Gloves
- Ladder/Step Stool
- Wire Nuts
- Level
- Open ceiling at least 10ft tall
- Mounting hooks or location installed to local code and capable of holding the weight of the system

NOTE: Three people are recommended for easy and proper installation

NOTE: This product was designed for use in an open ceiling

NOTE: Installation location and hardware must be capable of supporting 50lbs per anchor. If unsure, check with a qualified structural engineer.

INSTALLATION INSTRUCTIONS

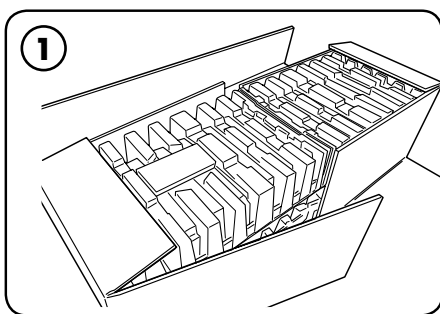

Before beginning installation, ensure that a qualified electrician has run a 120V circuit to the installation area.

Take out the mounting hardware box and verify included part quantity.

Fellowes strongly recommends a 4in, metallic, octagonal electrical box because it works best with the provided cover and strain relief.

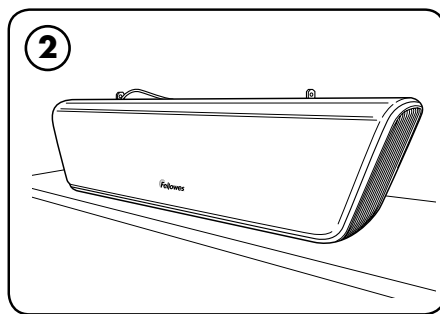

Remove unit from packaging and stage on temporary support trays on a tabletop or other surface under or near installation area.

CAUTION: leave support trays on or you may damage the product.

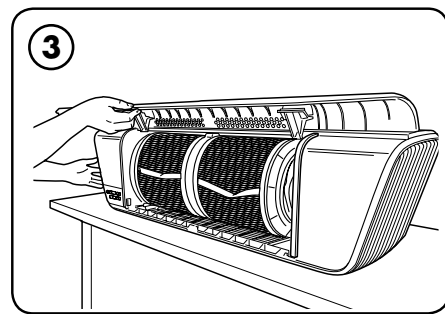

Open unit door by peeling back the tape as needed and gently pulling outward on the bottom of the door panel.

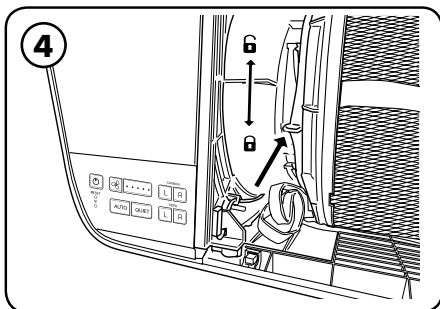

Disengage each filter clamp lever until a click is heard.

NOTE: Locking/ unlocking motions are in opposite directions between left and right filter changing mechanisms.

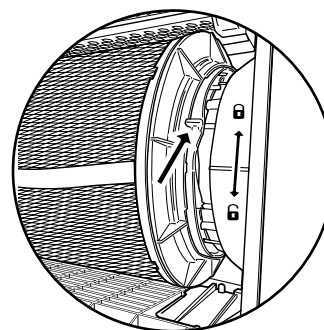
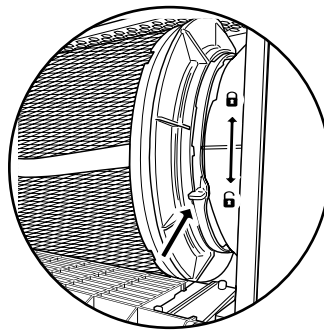
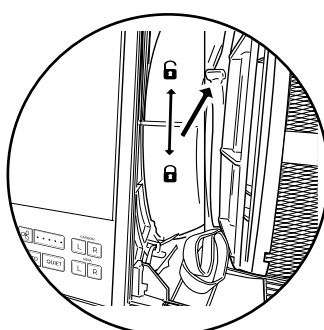

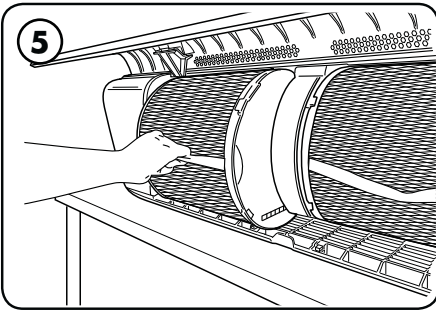

5
Pull each filter out by the strap and set aside for now.

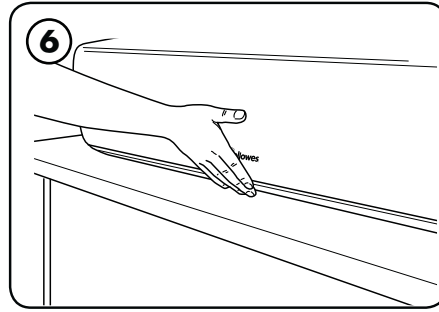

6
Close door until a click is heard.

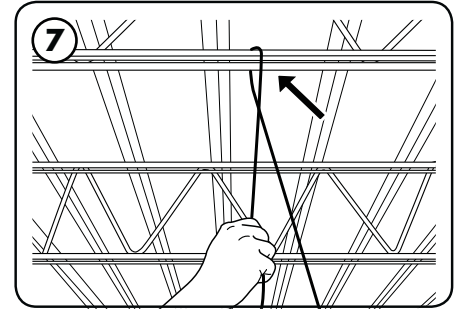

7
Depending on type of ceiling, attach proper mounting hardware above installation area at proper distances per local regulations for supporting a 45lb (21kg) fixture.

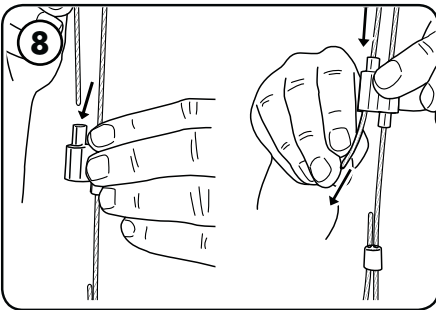

8
Loop open end of cables through intended truss.
Use provided cable clutch hardware to secure each cable.

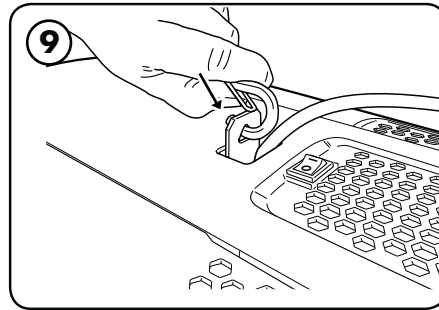

9
Secure the hooks from the provided aircraft cabling to the housing through the mounting holes.

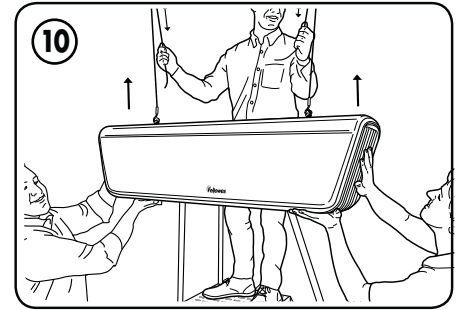

10
Have two people slowly lifting the machine while the other pulls the free end of the cables to keep them taut.
Alternate slowly raising each side to keep the unit relatively level during lifting.

⚠ CAUTION: three people are recommended for safe installation.

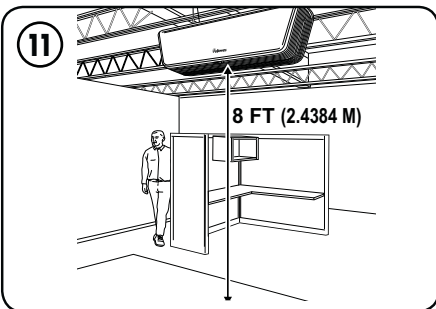

11
Raise the fixture to at least 8 feet off the ground.
For optimum performance, keep at least 12" of clearance between the top of the unit and the ceiling. Use a level to ensure the product hangs evenly.

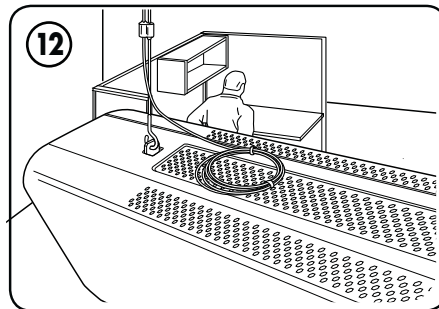

12
Coil and wrap remaining cable out of the way. Do not trim excess cable lengths.
Remove the support trays from the bottom of the unit and dispose of them.

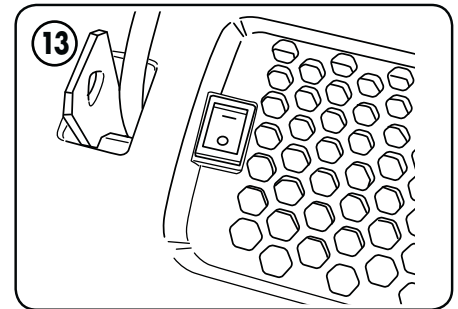

13
Ensure power switch located on the power supply is in the off position and the power to the breaker for the area is also off before proceeding with connecting.

Demandez l'aide d'un électricien qualifié afin de connecter les fils de ligne, neutre et de mise en terre à l'appareil conformément aux codes en vigueur.

To complete installation, install filters per filter instructions.

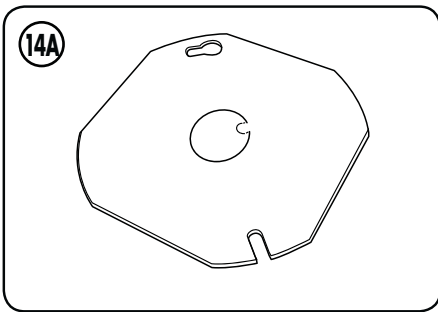

14A
Punch out the knockout from the electrical box cover.

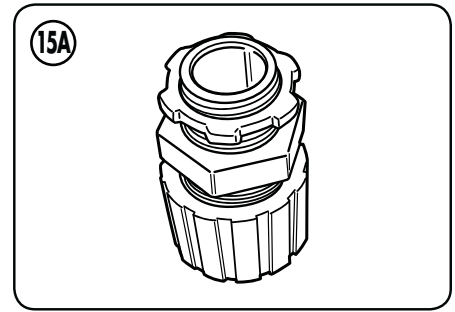
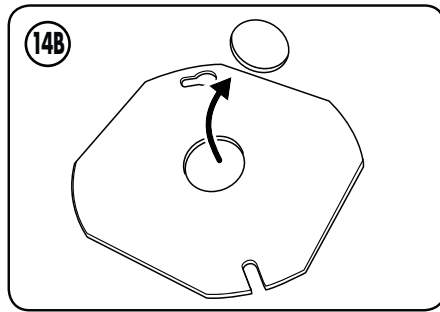

15A
Take off head, insert, and bushing of strain relief assembly.

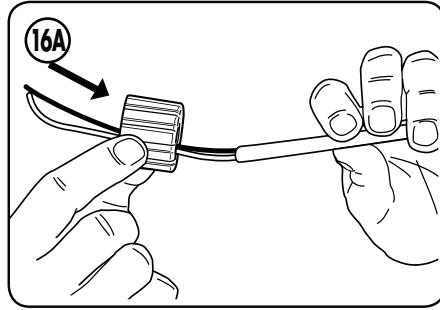
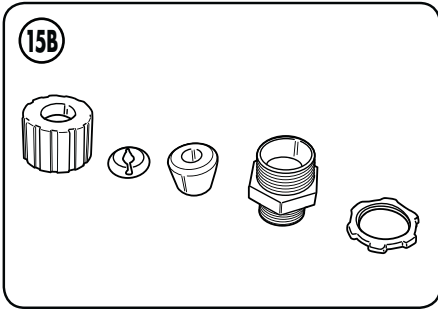

16A
Thread cable through strain relief head.

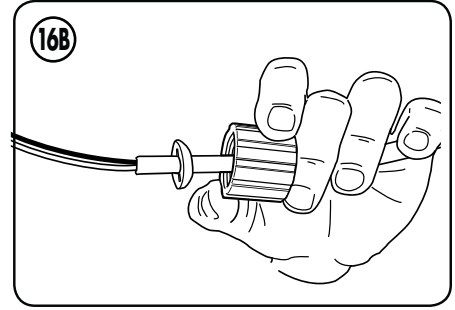

16B
Thread cable through strain relief insert.

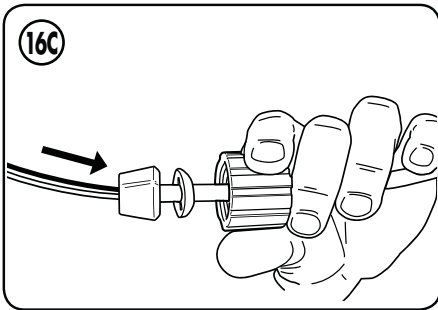

16C
Thread cable through strain relief bushing.

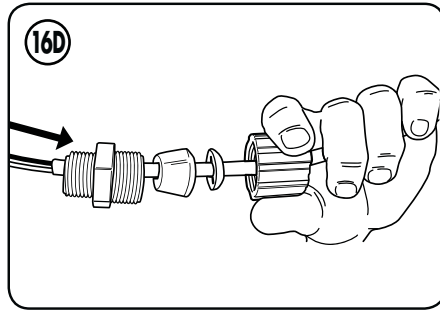

16D
Thread cable through strain relief base.

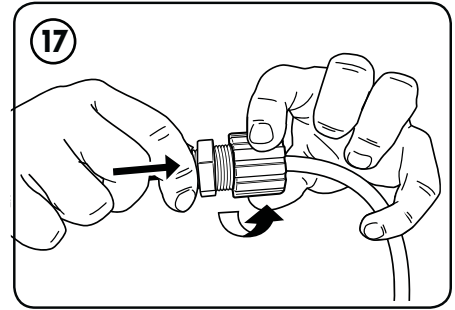

17
Gently twist strain relief components together - strain relief should still be able to move up and down the cable.

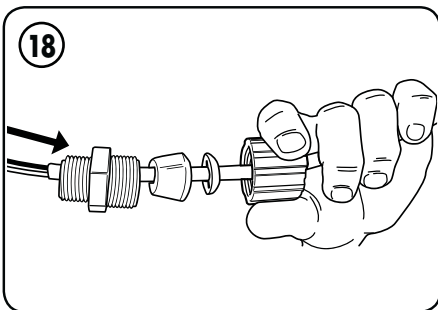

18
Thread cable through plate.

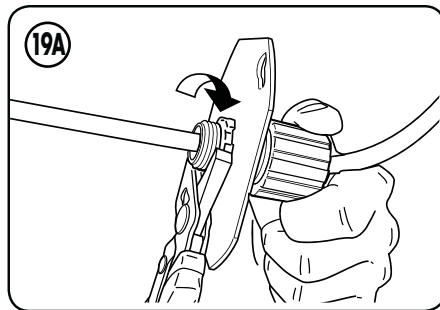

19A
Tighten strain relief nut to the plate with pliers.

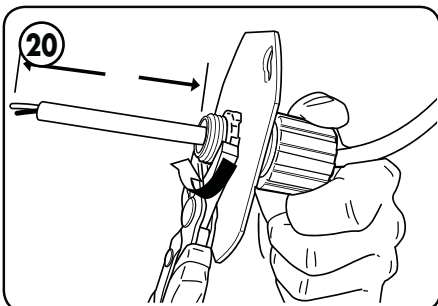
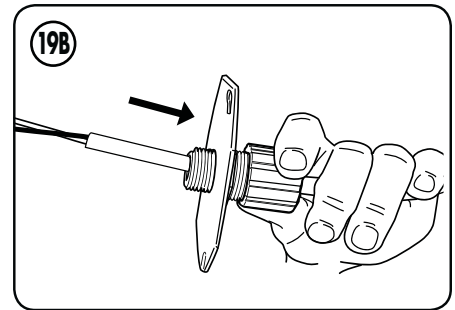

20
Determine required length of cable and cut allowing 3" that will stick into the electrical box. Tighten strain relief head to secure cord within assembly.

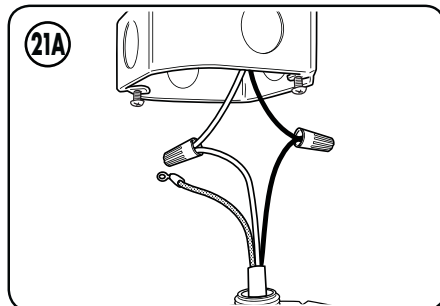

21A
Connect line, neutral and ground per local regulations.

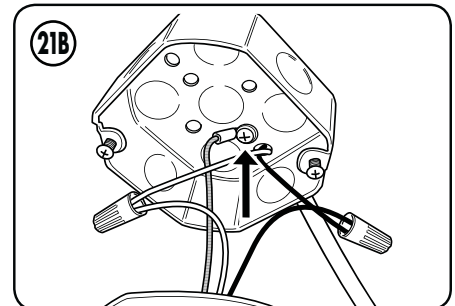

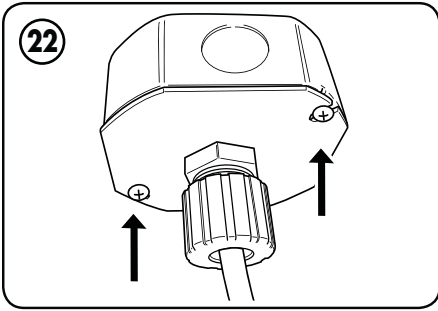

Fasten electrical box cover to electrical box.

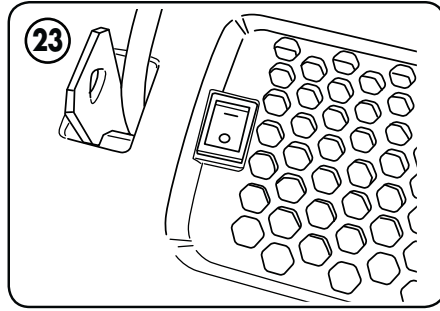

Flip power switch to the ON ("I") position. To complete installation, install filters per instructions below.

FILTER INSTALLATION PROCEDURE

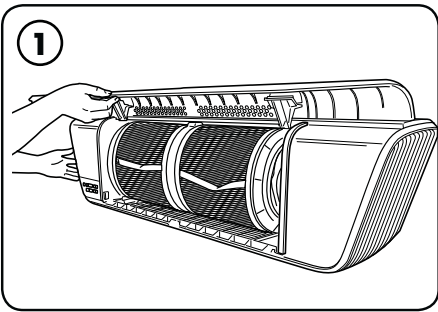

Open the door by gently pulling outward on the bottom of the door panel.

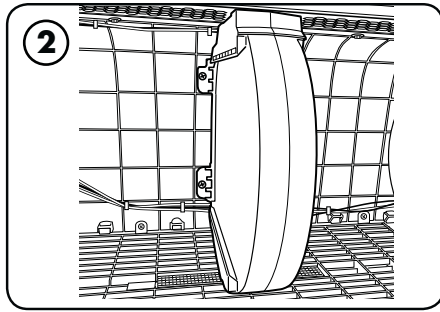

Remove new filters from protective bags and properly dispose of bags. One at a time, holding each filter by the strap, align support cleat with slot.

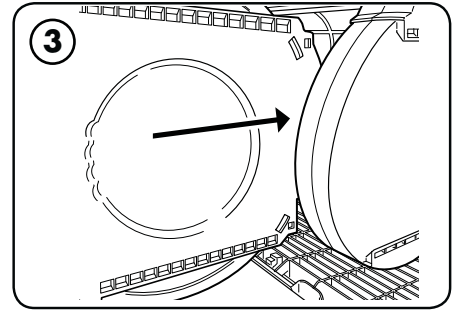

Gently push in filter until a click is heard. **NOTE:** if top and bottom supports are not properly aligned, the filter will not sit properly and can damage the unit.

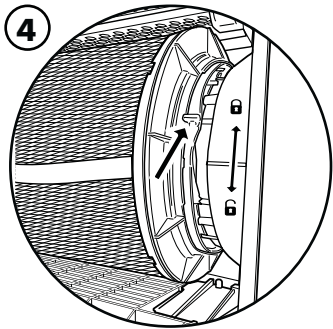

Secure filter into place by moving filter clamp lever back into the locked position until a click is heard.

Repeat steps for second filter.

NOTE: Locking/unlocking motions are in opposite directions between left and right filter changing mechanisms.

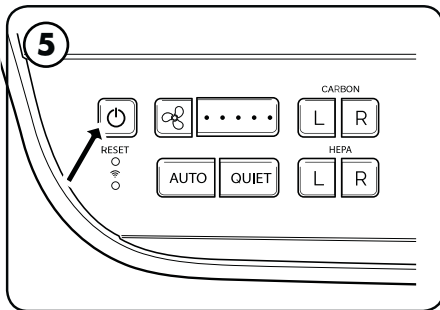

Press the power button to turn the unit on.

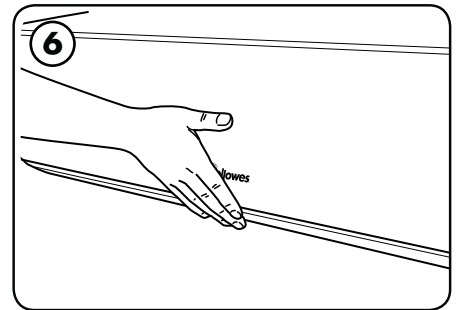

Close the door until a click is heard.

Fellowes

A I R P U R I F I E R S

Array AC2

Ceiling Mounted Air Purifier
Purificateur d'air monté au plafond
Purificador de aire de techo



Owner's Manual
Manuel du propriétaire
Manual del propietario

PLEASE READ THESE INSTRUCTIONS BEFORE USE.
DO NOT DISCARD: KEEP FOR FUTURE REFERENCE.

VEUILLEZ LIRE CES INSTRUCTIONS AVANT D'UTILISER L'APPAREIL.
NE PAS JETER : CONSERVER AFIN DE CONSULTER LES DIRECTIVES
ULTÉRIEUREMENT, EN CAS DE BESOIN.

LEA ESTAS INSTRUCCIONES ANTES DEL USO.
NO LAS DESECHE: CONSÉRVELAS PARA REFERENCIA FUTURA.

***For a copy of the manual please visit www.fellowes.com**

⚠ WARNING: IMPORTANT SAFETY INSTRUCTIONS — Read Before Using!

Please read and save these instructions. Read carefully before attempting to assemble, install, operate or maintain this product. Protect yourself and others by observing all safety information. Failure to comply with instructions could result in personal injury and/or property damage. Retain instructions for future reference.

⚠ WARNING – TO REDUCE THE RISK OF FIRE, ELECTRIC SHOCK, OR INJURY TO PERSONS, OBSERVE THE FOLLOWING:

- a) Use this unit only in the manner intended by the manufacturer. If you have questions, contact the manufacturer.
 - b) Before servicing or cleaning unit, switch power off at service panel and lock the service disconnecting means to prevent power from being switched on accidentally. When the service disconnecting means cannot be locked, securely fasten a prominent warning device, such as a tag, to the service panel.
- Do not use this air purifier as sole protection against harmful pollutants.
 - Do not repair or modify the product unless specifically recommended in this manual. Only an authorized repair technician should disassemble, repair, or modify this product.
 - Installation work and electrical wiring must be done by qualified person(s). All electrical installation work must be conducted and carried out in accordance with all federal, state, and local codes and regulations.
 - Do not install this product near heat-generating equipment.
 - This product will not remove carbon monoxide emitted from heating appliances or other sources.
 - Do not use the product near flammable substances or a gas leak.
 - The product must be grounded.
 - Use only the electrical power (voltage and frequency) specified for the model air purifier being installed.
 - If drilling into mounting surface, do not damage electrical wiring or other hidden utilities.
 - Do not touch the power cord with wet hands. It may result in electrical shock.
 - Do not use the unit where it is humid or where the unit may get wet.
 - Do not attempt to carry this product by the cord.
 - Do not use if the power cord or plug is damaged. If the power cord is damaged, it must be replaced by the manufacturer or a qualified technician.
 - Not suitable for use with solid state speed controls.
 - Do not obstruct the air inlet or air outlet.
 - This product is for indoor use only.
 - Change your filters at the recommended intervals to avoid particle and dust buildup.
 - Ensure filter bags are removed and correctly installed before turning on. Do not operate this product without filters.
 - Do not wash and reuse any of the filters.
 - Do not use attachments or filters other than Fellowes brand, as product will not function.
 - Do not spray aerosols on, or into the product.
 - Do not use detergent to clean the product.
 - Do not insert fingers, liquids, or foreign objects into the air intake or outlets.
 - Do not use this product for anything other than air purification.
 - This appliance can be used by children aged from 8 years and above and persons with reduced physical, sensory, or mental capabilities or lack of experience and knowledge if they have been given supervision or instruction concerning use of the appliance in a safe way and understand the hazards involved.
 - This device contains licence-exempt transmitter(s)/receiver(s) that comply with Innovation, Science and Economic Development Canada's licence-exempt RSS(s). Operation is subject to the following two conditions:
 1. This device may not cause interference.
 2. This device must accept any interference, including interference that may cause undesired operation of the device.

PRODUCT SPECIFICATIONS

Dimensions	49 X 13 X 14.5 in	1245 X 330 X 368 mm
Weight of System	47 lbs	21.3 kg
Power Requirements	AC 120V 60Hz 1.2A	
Watts (5 fan speeds)	120W	

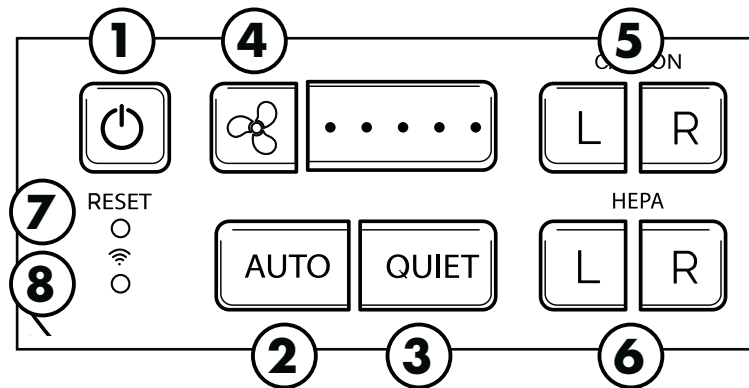

NOTE: To access unit controls, open unit door by gently pulling outward on the bottom of the door panel

- 1 POWER** – Press - sets the unit to OFF or ON mode.
 OFF Mode: All indicators are off, fans are off, sensors still collect data, only power button is ON.
 ON mode: Initializes into Auto mode. Subsequent uses set unit at the last mode setting (Manual/Auto/Quiet). Fans on, sensors on, Air Quality Indicator light on:
 – BLUE when air quality is Good.
 – AMBER when air quality is Fair.
 – RED when air quality is Poor.
 – WHITE when door is open.
- 2 AUTO** – Press: sets the unit to Auto mode.
 Light: indicates unit is running in Auto mode where air quality sensors set fan speed automatically depending on environment.
 Indicator will stay lit if feature is active, but will only function if door is closed.
- 3 QUIET** – Press: sets the unit to Quiet Auto mode.
 Light: indicates unit is running in Quiet Auto mode where air quality sensors set fan speed automatically depending on environment but will not exceed fan speed 3.
 Indicator will stay lit if feature is active, but will only function if door is closed.
- 4 MANUAL** – Press: cycle through fan speeds. If coming from Auto mode, will start at lowest fan speed.
 Light: indicates which fan speed is currently selected (1-5).
- 5 CARBON FILTER** – Press for 2s: reset the life counter of the carbon filter.
 Light (red): indicates filter life has reached 100%. An external LED will also light (red) if any filter is over 100% life.
 L button is for Left side.
 R button is for Right side.
- 6 HEPA FILTER** – Press for 2s: reset the life counter of the HEPA filter.
 Light (red): indicates filter life has reached 100%. An external LED will also light (red) if any filter is over 100% life.
- 7 RESET** – Press for 10s: connection reset.
- 8 WIRELESS STATUS** –
 GREEN = Fully Connected & Paired
 YELLOW = Connection Available
 RED = Not Connected
 RED (Blink) = Connection Error
 BLUE = Reset Initialized
 BLUE (Blink) = Reset Confirmed
 OFF = Connection Disabled

FILTER CHANGE PROCEDURE

Unit will notify you when filter needs to be changed with a red LED visible on the bottom of the unit. Always wear a mask and gloves when performing a filter change. For replacement filters, please visit: www.fellowes.com

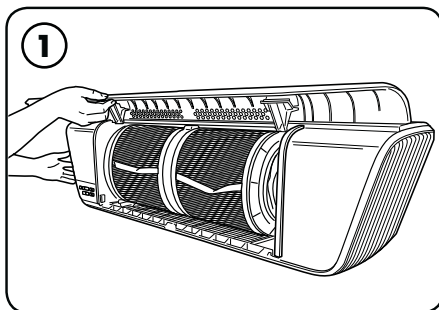

Open the door by gently pulling outward on the bottom of the door panel.

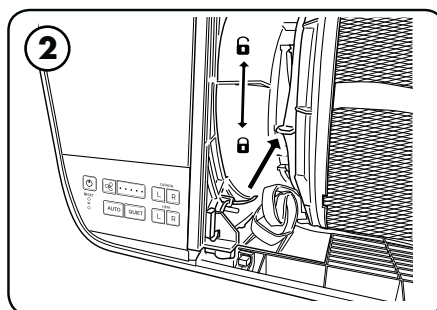

Disengage the filter clamp lever until a click is heard, pull used filter out by the strap and dispose.

NOTE: Locking/unlocking motions are in opposite directions between left and right filter changing mechanisms.

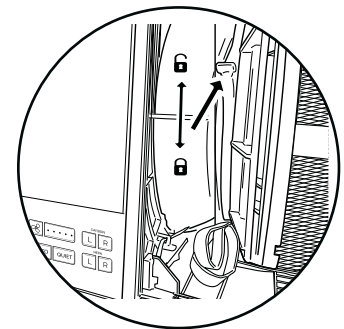

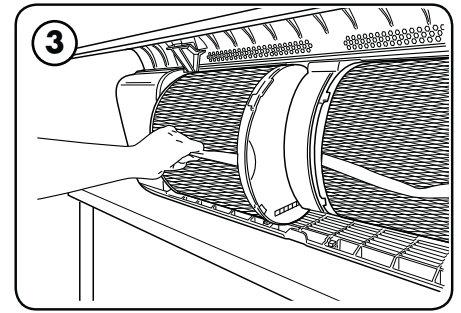
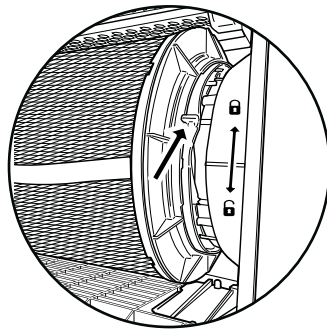
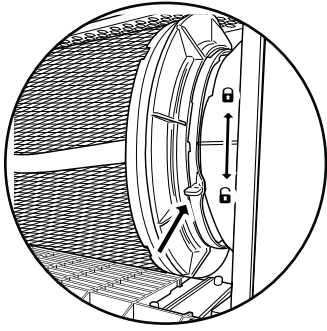

3 Pull each filter out by the strap and set aside for now.

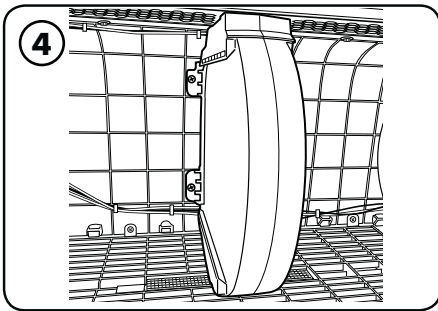

4 Remove new filters from protective bags and properly dispose of bags.
One at a time, holding each filter by the strap, align support cleat with slot.

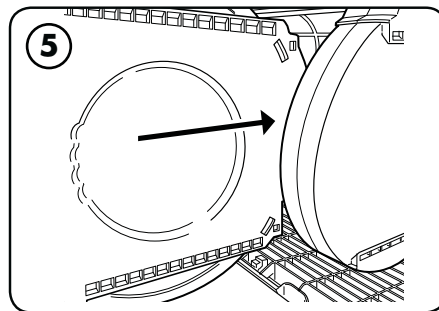

5 Gently push in filter until a click is heard.
NOTE: if top and bottom supports are not properly aligned, the filter will not sit properly and can damage the unit.

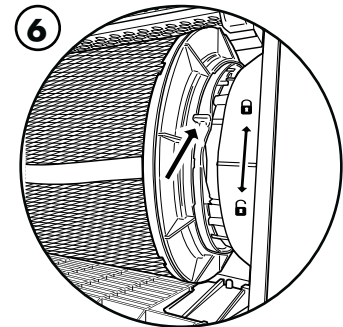

6 Secure filter into place by moving filter clamp lever back into the locked position until a click is heard.
Repeat steps for second filter.
NOTE: Locking/unlocking motions are in opposite directions between left and right filter changing mechanisms

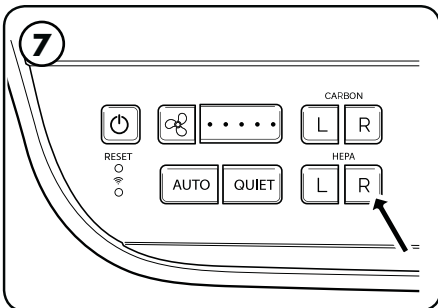

7 Press the carbon or HEPA filter buttons that are lit up to reset the filter life indicators.

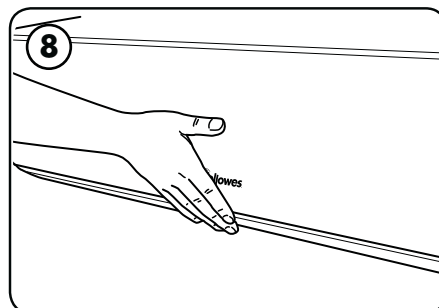

8 Close the door until a click is heard.

WIRELESS CONNECTION – GETTING STARTED

This product has additional features that are only available when using the online dashboard.

To get started, please visit www.arrayviewpoint.fellows.com

If you have questions or need help along the way, please contact us at 1-800-955-0959

MAINTENANCE AND CLEANING

Power down machine and remove filters before starting maintenance (See Filter Installation/Removal Guide).

Use dust cloth to remove dust and debris that may have built up around the unit internals.

Note: Do not attempt to clean inside fan blade area. Damage may occur to blades.

Note: Do not use the dust cloth to clean the filters.

If there is dust and debris near the exhaust areas of the unit, gently use a dust cloth to loosen the dust.

Once complete, reinstall the filters, turn the unit on, and close the door.

TROUBLESHOOTING

PROBLEM:	POSSIBLE SOLUTION:
How do I turn on the unit?	Make sure the power switch on top of the unit is flipped to the on position, indicated by the 'I' symbol. Next, open the door and press the power button on the control panel.
What does the red light under the unit mean?	This means the filter needs to be replaced. Please replace and reset the indicator.
How do I reset my filters life indicator?	Press the "HEPA Filter" button until it is no longer red.
How do I get the filters out of the unit?	Ensure the finger paddle on the filter change mechanism is in the unlocked position. Then grab the filter handle strap and firmly pull on the filter to dislodge.
How do I get the filters back into the unit?	Ensure finger paddle on the filter change mechanism is in the unlocked position, the filter is oriented so the French cleat support can be used, and the French cleat is seated correctly.

LIMITED WARRANTY

Fellows, Inc. ("Fellows") warrants the Fellowes Commercial Grade Air Purifier ("Product") to be free from defects in material and workmanship for the time periods as set forth below.

The particle counters, IOT, and sensors for a period of three (3) years from the date of original purchase of the Product.

All other parts for a period of five (5) years from the date of original purchase of the Product.

In the event that the Product is installed into new construction, the warranty period shall commence on the date of the occupancy permit or one year after the date of purchase, whichever is earlier. If any part is found to be defective during the warranty period, Fellowes will (at its sole option) either repair or replace the defective product with no charge for service or parts.

This warranty does not cover damage caused by use of non-Fellows approved filters or failure to follow the recommended replacement schedule. This warranty does not apply in the cases of abuse, mishandling, failure to comply with product usage standards, operation using an improper power supply (other than listed on the label), installation error, or unauthorized repair. This warranty does not cover replaceable filters.

Fellows reserves the right to charge the consumer for any additional cost occurred by Fellowes to provide parts or service outside of the country where the Product was initially sold by an authorized reseller. In the event that the Product is not readily accessible to Fellowes designated service personnel, Fellowes reserves the right to supply the customer with replacement parts or product in full satisfaction of its obligations under this warranty and any service obligations. **ANY IMPLIED WARRANTY, INCLUDING THAT OF MERCHANTABILITY OR FITNESS FOR A PARTICULAR PURPOSE, IS HEREBY LIMITED IN DURATION TO THE APPROPRIATE WARRANTY PERIOD SET FORTH ABOVE.** In no event shall Fellowes be liable for any consequential, incidental, indirect or special damages. This warranty gives you specific legal rights. The duration, terms, and conditions of this warranty are valid worldwide, except where different limitations, restrictions, or conditions may be required by local laws. For more details or to obtain service under this warranty, please contact us or your dealer.

INFORMATION TO THE USER

This product is classified as Electrical and Electronic Equipment. Should the time come for you to dispose of this product please ensure that it is not mixed with general household waste. For proper treatment, recovery, and recycling, please take this product to a designated collection point. Please contact your local authority for further details of your nearest designated collection point"

"This equipment has been tested and found to comply with the limits for Class B digital device, pursuant to part 15 of the FCC Rules. These limits are designed to provide reasonable protection against harmful interference in an installation. This equipment generates, uses and can radiate radio frequency energy and, if not installed and used in accordance with the instructions, may cause harmful interference to radio communications. However, there is no guarantee that interference will not occur in a particular installation. If this equipment does cause harmful interference to radio or television reception, which can be determined by turning the equipment off and on, the user is encouraged to try to correct the interference by one or more of the following measures:

- Reorient or relocate the receiving antenna.
- Increase the separation between the equipment and receiver.
- Connect the equipment on a circuit different from that to which the receiver is connected.
- Consult the dealer or experienced radio/TV technician for help.